

# Bumper Assembly Instructions

## Tools Required:

- #2 Phillips screw driver
- 11/32 Nut driver or wrench

- 1.) Place corner bumper on front corner of flip tray
- 2.) With #2 Phillips screw driver insert 1 #10-32 screw into first hole and tighten until rubber is compressed.
- 3.) Repeat step 2 (3) more times.
- 4.) Follow steps 1-3 for opposite side.

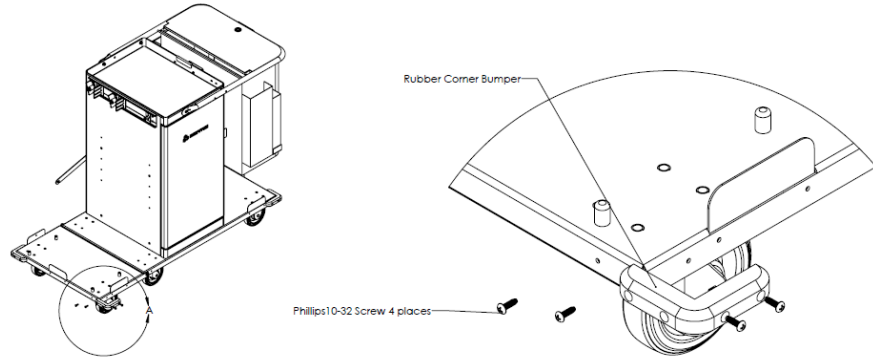

# Install Instructions For Front Flip Tray

- 1.) Locate Hole in Front side of cart (opposite the handle)
- 2.) Insert Bushing #1 into Hole from outside of tray.
- 3.) Position flip tray to align large hole with bushing in step #2.
- 4.) Install Bushing #2 into large hole in flip tray from outside
- 5.) Push bolt through bushing #2, Flip tray, Bushing #1, Cabinet tray.
- 6.) Put flat washer on thread end of bolt sticking out after step #5.
- 7.) Thread Nut onto end of bolt and tighten down with 1/2" wrench and 3/16 Allen wrench
- 8.) Follow steps 1-7 for other side of tray.

## Tools:

- 1.) 1/2" Box end Wrench
- 2.) 3/16 Allen Hex Wrench

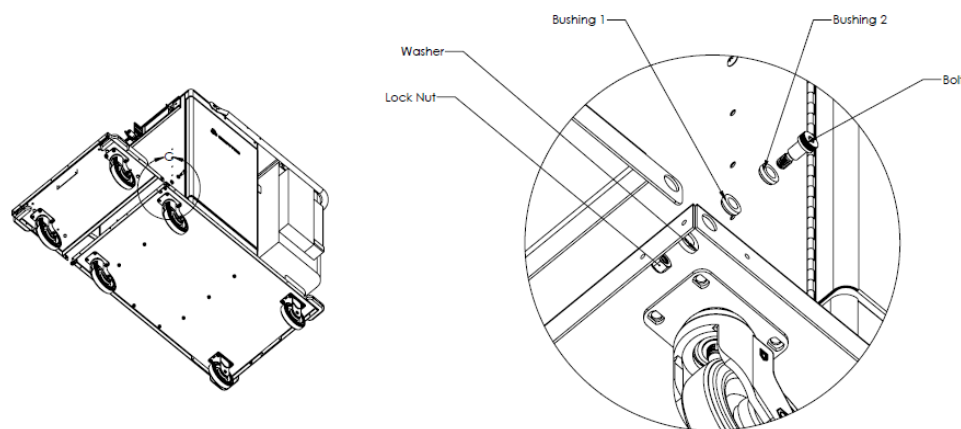

# Space Station Installation instructions

- 1) Place Space station on top tray of cart with window side of the space station facing the cart door.
- 2) Install #42 Screw through holes of cabinet. Make sure space station is pushed to the back of cabinet (away from door) until it is flush with inside of the top tray. There should be no gap along the back wall. Put washer # 67 on screw #42 once it is pushed through cabinet and space station, install nut # 43 finger tight. Repeat this step 3 times, 2 screws on the left side and one screw on the right side.
- 3) Install #40 Bolt through handle, cart and space station. Place #38 stainless steel washer on bolt. Place # 18 nut on #40 bolt and tighten down keeping space station sitting flat on top tray.
- 4) Go back to step #2 Tighten down all 3 screws making sure space station is held back against the top tray. (Over)

## Tools Required

- 11/32 nut driver or box end wrench
- 7/16 box end wrench
- #2 Phillips Screw driver

Item #	Description	Qty
18	1/4-20 Lock Nut	1
38	SS Washer	1
40	1/4-20x3/4 Bolt	2
43	#8-32X.5 Bolt	2
41	#8-32 Lock Nut	4
45	#8-32X.375 TRS HD Bolt	1
65	SS Fender washer	3

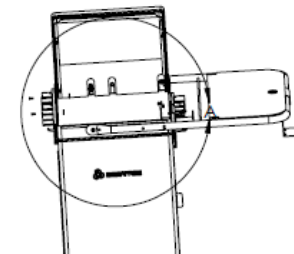
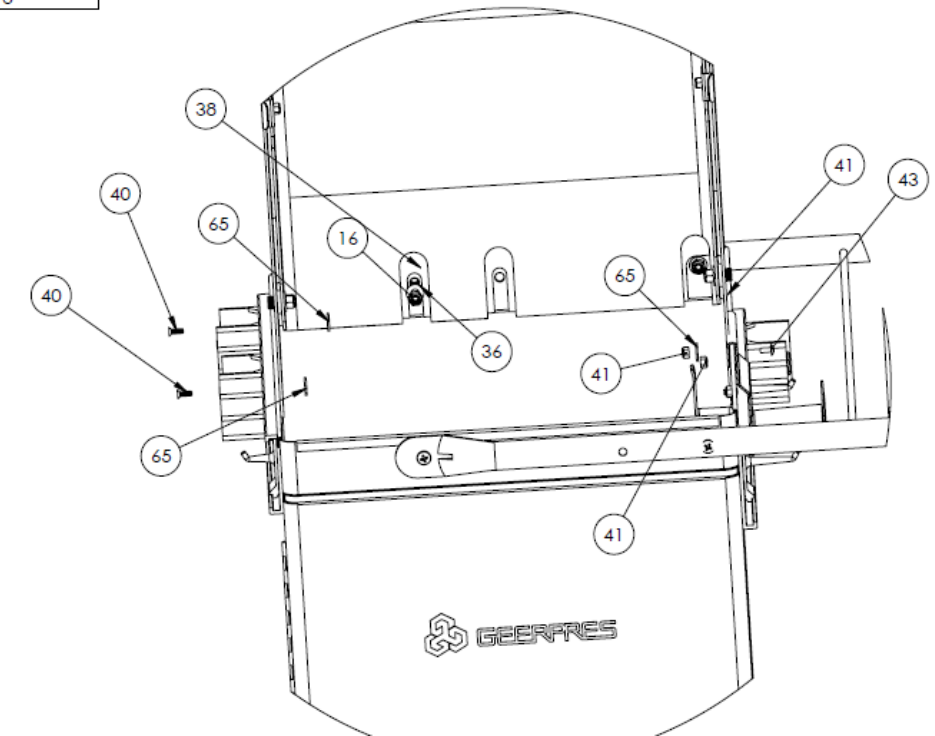

## Shelf Adjustment Instructions

**Tools Required:** #2 Philips screw driver, 11/32 nut driver or wrench

- 1) Determine what height you need for your shelves. Place shelf into cabinet with notches facing the back of the cabinet and formed legs facing down. Align holes with position in cabinet you wish to use.
- 2) Install #45 Screw in back hole on shelf on each side first finger tight. Lift front of shelf up to align front holes to level position with back-holes and install 2 more #45 screws tighten all 4 screws.
- 3) Repeat step 1 & 2 for second Shelf.

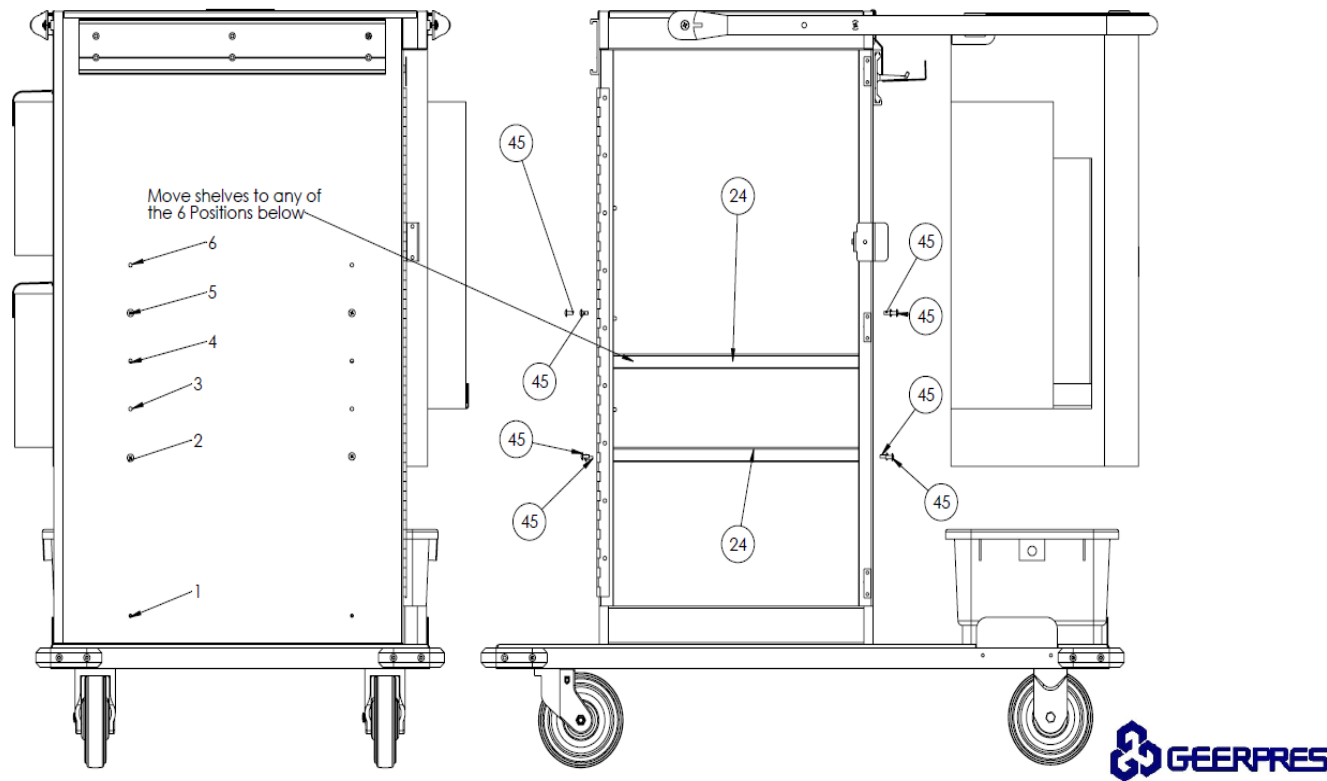

## Flip Tray Catch Arm Install Instructions

- 1). Pick hole position for size of tray purchased with cart. Place screw through arm with countersink facing away from cabinet.
- 2). Place 2 plastic washers between arm can cabinet. Put through proper hole from #1 and put nut on screw from inside cabinet. Tighten so arm moves freely but not so loose that it will swing and hit the cabinet.

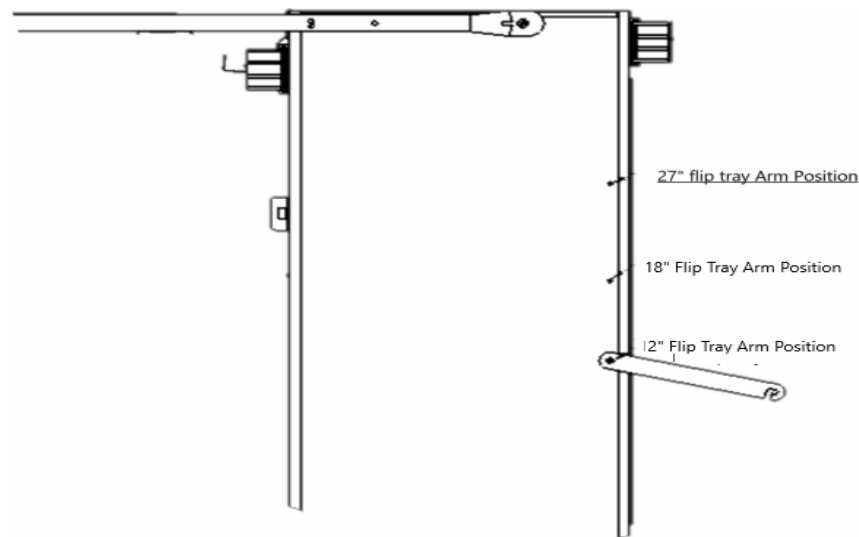

### Tools Required

#2 Philips screw driver

11/32 Nut driver or box end wrench

- Items for install
- Stainless steel arm 1
- Plastic washers 2
- SS lock nut 1
- 8-32 bolt 1

## Handle Install Instructions

**Tools:** Philips Head Screwdriver / 7/16 Box end wrench

Handle can be placed in two positions to fit users' specific needs.

**Option 1.** Used for use with the C-zipper or dry dock bag. Use Handle Position 1 hole

- 1). Install Bolt #35 through the end of handle opening, place #32 Plastic washer on back side of handle facing cabinet.
- 2). Push Bolt #35 through cabinet hole in handle position # 1 or #2 depending on length of handle desired.
- 3). Place stainless washer # 34 on bolt sticking through inside of cabinet.
- 4). Install Stainless steel lock nut #15 on bolt and tighten.
- 5). Place 1.5 long Stainless bolt #33 through hole in handle and place #32 plastic washers on end of bolt facing cabinet.
- 6). Push bolt through in cabinet place stainless steel washer on end of bolt.
- 7). Place #15 Stainless nut on bolt and tighten.
- 8). Repeat steps 1-7 for opposite side.

**Option 2.** Used for use with the microfiber bag option.

- 1). Install Bolt #35 through the end of handle opening, place #32 Plastic washer on back side of handle facing cabinet.
- 2). Push Bolt #35 through cabinet hole in handle position # 1 or #2 depending on length of handle desired.
- 3). Place stainless washer # 34 on bolt sticking through inside of cabinet.
- 4). Install Stainless steel lock nut #15 on bolt and tighten.
- 5). Place 1.5 long Stainless bolt #33 through hole in handle and place #32 plastic washers on end of bolt facing cabinet.
- 6). Push bolt through in cabinet place stainless steel washer on end of bolt.
- 7). Place #15 Stainless nut on bolt and tighten.
- 8). Repeat steps 1-7 for opposite side.

Item #	Description
17	SS Nut
34	Plastic spacer
33	1/420x1.5 Bolt
36	SS Washer
35	1/420x3/4 Bolt

DETAIL A  
SCALE 2:3

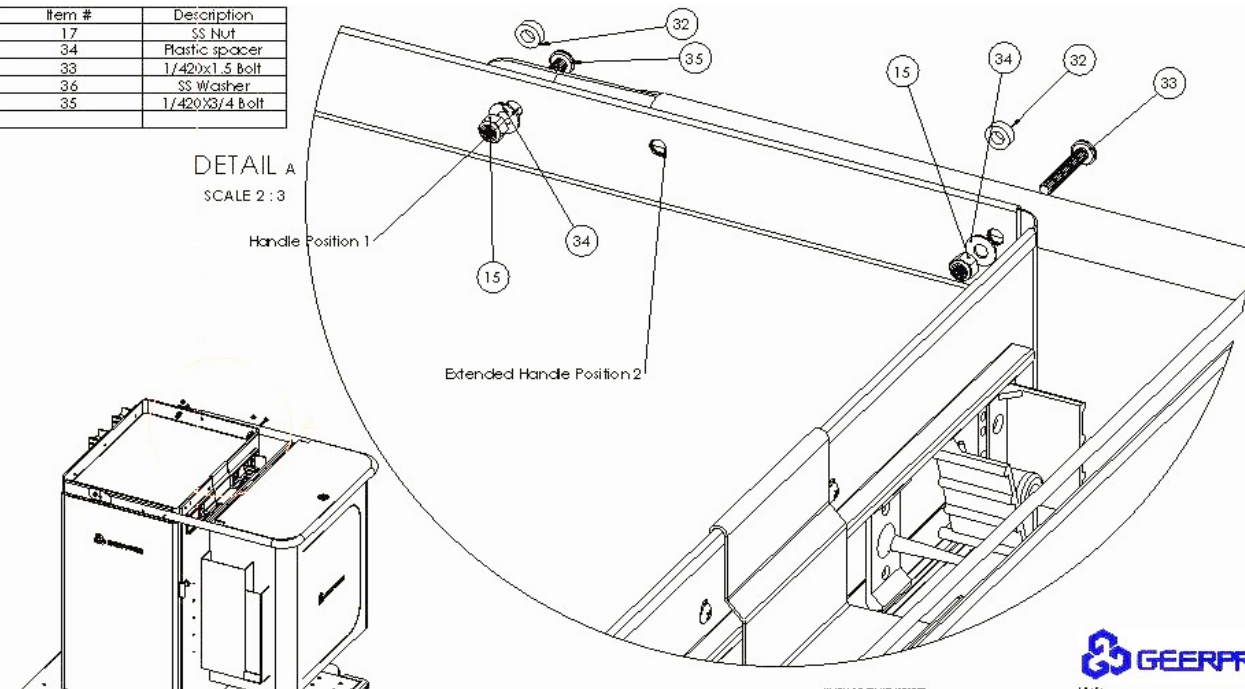

GEERPRES